

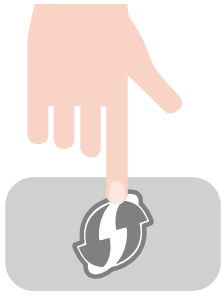

With WPS

Turn on WPS on your router.
It will stay on for 2 min.



Connect the SmartBridge to the smart meter.

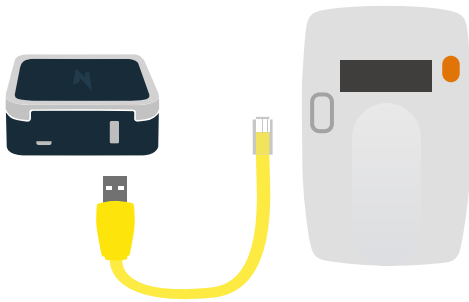
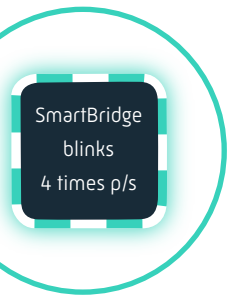

The SmartBridge will connect to the Internet.

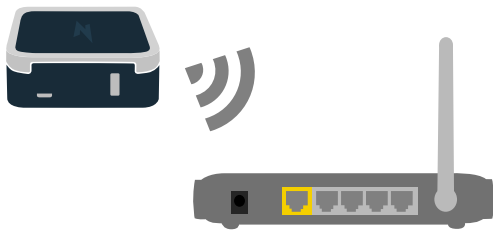
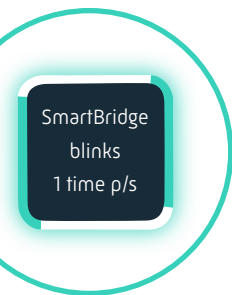

When the SmartBridge light stops blinking, it's ready for use.



Without WPS

1

Connect the SmartBridge to the smart meter.

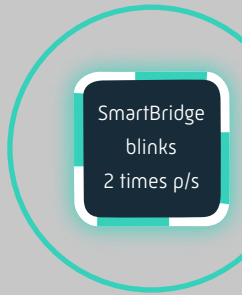
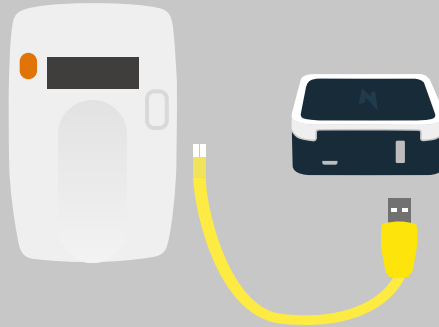

2

Open the app and go to 'Connect to SmartBridge'.

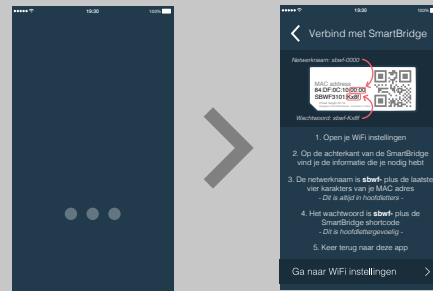

Follow the instructions on the screen.

3



When the SmartBridge light stops blinking, it's ready for use.

4



Download the app on:

android.net2grid.com
ios.net2grid.com

Check the SmartBridge dashboard on:
<http://smartbridge.local>